

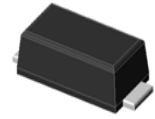

Features

- Low VF Schottky barrier diodes
- Low profile - typical height of 1.0 mm
- Low forward voltage drop
- Low leakage current
- Moisture sensitivity: level 1, per J-STD-020
- High temperature soldering guaranteed: 260°C/10 seconds
- Halogen-free according to IEC 61249-2-21 definition



eSGP(SOD-323F)



Maximum Ratings ($T_A = 25^\circ\text{C}$ unless otherwise noted)

Parameter	Symbol	SPGPD220S	SPGPD240S	SPGPD260S	SPGPD2BS	Unit
Maximum repetitive peak reverse voltage	VRRM	20	40	60	100	V
Maximum RMS voltage	VRMS	14	28	42	70	V
Maximum DC blocking voltage	VDC	20	40	60	100	V
Maximum average forward rectified current	IF(AV)	0.2				A
Peak forward surge current 8.3 ms single half sine-wave superimposed on rated load	IFSM	10				A
Operating junction and storage temperature range	TJ, TSTG	- 55 to + 150				°C

Electrical Characteristics ($T_A = 25^\circ\text{C}$ unless otherwise noted)

Parameter	Test Conditions	Symbol	SPGPD220S	SPGPD240S	SPGPD260S	SPGPD2BS	Unit
Maximum instantaneous forward voltage	0.2A	V_F	0.45	0.50	0.60	0.80	V
Maximum DC reverse current at rated DC blocking voltage	$T_A=25^\circ\text{C}$	I_R	80.00		50.00		uA
	$T_A=125^\circ\text{C}$		30				mA
Typical junction capacitance	4.0 V, 1 MHz	C_J	18	13	12	9	pF
Typical thermal resistance	junction to mount	$R_{\theta JM}$	55				°C/W

Note:1),The thermal resistance from junction to mount,mounted on P.C.B with 5x5mm copper pads,2 OZ,FR4 PCB

Ratings and Characteristics Curves ($T_A = 25^\circ\text{C}$ unless otherwise noted)

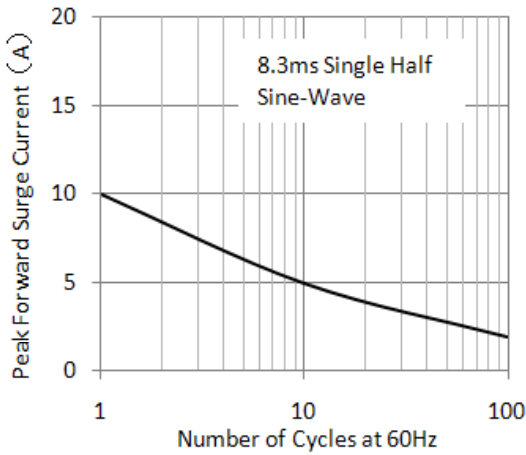

Figure 1. Maximum Non-Repetitive Peak Forward Surge Current

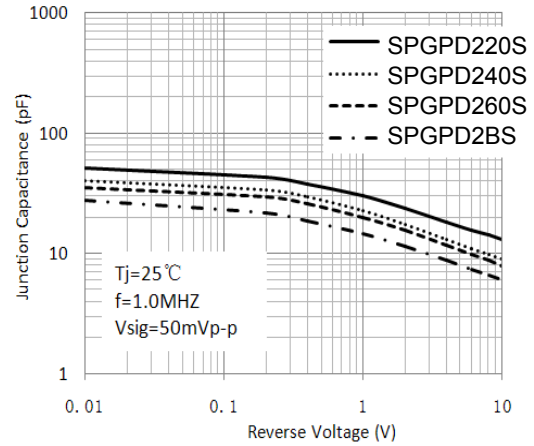

Figure 2. Typical Junction Capacitance

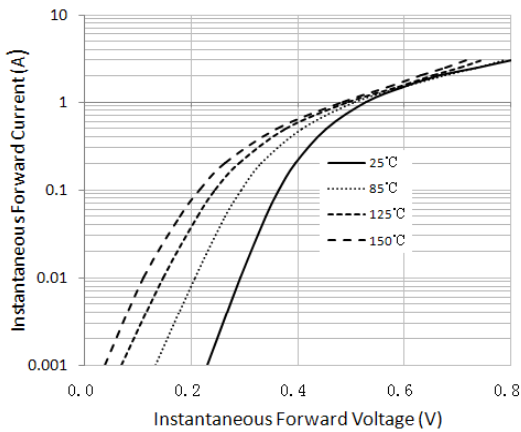

Figure 3. Typical Instantaneous Forward Characteristics (SPGPD220S)

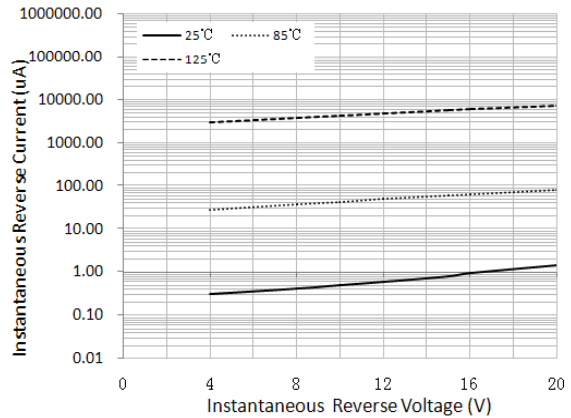

Figure 4. Typical Reverse Characteristics (SPGPD220S)

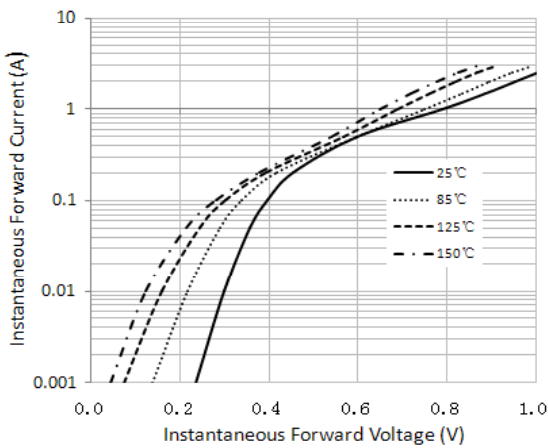

Figure 5. Typical Instantaneous Forward Characteristics (SPGPD240S)

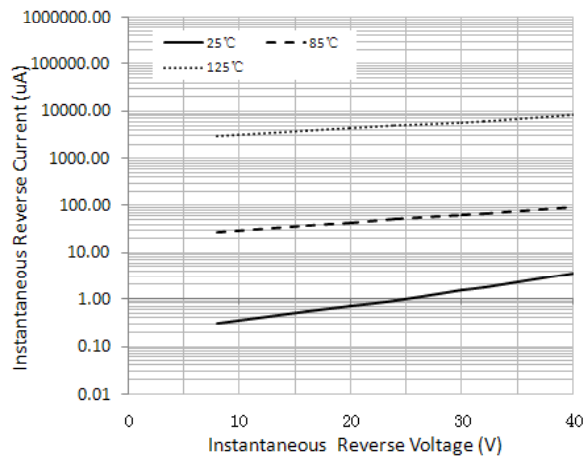

Figure 6. Typical Reverse Characteristics (SPGPD240S)

Ratings and Characteristics Curves

($T_A = 25^\circ\text{C}$ unless otherwise noted)



SPGPD220S thru SPGPD2BS

Surface Mount Schottky Rectifier
Reverse Voltage 20-100V Forward Current 0.2A

eSGP(SOD-323F)

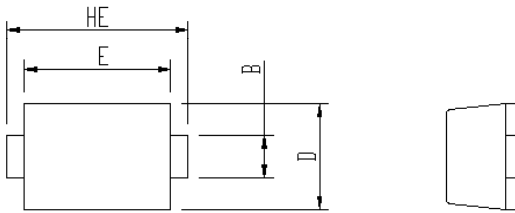

Package	Unit:mm		Unit:inch	
	MIN	MAX	MIN	MAX
eSGP				
A	0.9	1.08	0.035	0.043
B	0.5	0.7	0.020	0.028
C	0.1	0.25	0.004	0.010
D	1.4	1.6	0.055	0.063
E	2.0	2.2	0.079	0.087
L	0.35	0.65	0.014	0.026
HE	2.4	2.8	0.094	0.110

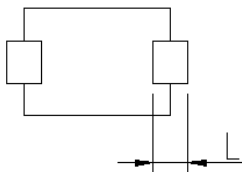
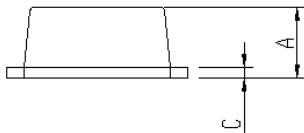

Soldering footprint

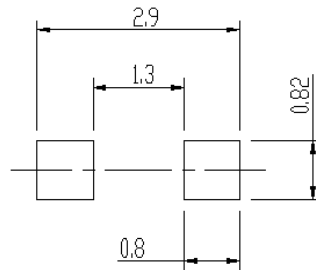

Packing Information

Packing Quantities:

3000 pcs/Reel, 40 Reels/Box; 8mm Tape, 7" Reel

Tape & Reel Specification

